



AG-1600 Antibacterial Vaporizer

USER MANUAL

- ENGLISH





Safety Information



Thank you for choosing Air Guard. Please read the following safety information carefully before operating the machine. This information includes important safeguards about installation, usage, and maintenance. Pay attention to all warning labels and instructions in this manual and printed on the machine.

- Keep this device dry.
- Always connect to a grounded circuit to avoid risk of electrocution.
- Before connecting the machine to power, always check the voltage indicate on the machine matches to your local AC voltage. Do not use the machine if AC power voltage does not match.
- Disconnect the machine from AC power before servicing and when not in use.
- If the supply cord is damaged, contact your local dealer for replacement.
- This product is for indoor use only! Do not expose to rain or moisture. If fluid is spilled, disconnect AC power and clean with a damp cloth. If fluid is spilled onto electronic parts, immediately unplug the machine and contact your local dealer for advice.
- No user serviceable and modifiable parts inside. Never try to repair this product, an unauthorized technician may lead the machine to damage or malfunction.
- For adult use only. Children being supervised not to play with the machine. Never leave the machine running unattended.
- The machine is not to be used by persons (including children) with reduced physical, sensory or mental capabilities, or lack of experience and knowledge.
- Installed in a well ventilated area. Provide at least 50 cm space around the machine.
- Never add flammable liquid of any kind to the machine.
- Make sure there are no flammable materials close to the machine while operating.
- Only use Air Guard Antibacterial Solution. Other solution may lead to heater clog and malfunction.
- If the machine fails to work, unplug the machine and stop operation immediately. Contact your local dealer for advice .
- Before transporting the machine, make sure the fluid tank is completely drained.
- Do not drink Air Guard solution. Store it securely. In case of eye contact, immediately look for medical advice.

Unpacking and Inspection

Immediately upon receiving the antibacterial vaporizer, carefully unpack the carton, check the content to ensure that all parts are present and have been received in good condition. If any parts appear damaged or mishandled from shipping, notify the shipper immediately and retain the packing material for inspection.

What are included:

- 1 x AG-1600 Antibacterial Vaporizer
- 1 x Wireless Remote Control
- 1 x Power Cord
- 1 x User Manual

Product Dimensions



Product Overview



Setting Up

Step 1: Place the machine on a flat surface and in a suitably large area with at least 50 cm open space at each side of the machine and 2 meters for the output direction of the machine.

Step 2: Fill the fluid tank with Air Guard fluid.

Step 3: Connect the machine to suitably rated power supply. To determine the power requirement for the machine refer to the label on the back of the machine.



Always connect the machine to a protected circuit and ensure it is properly grounded to avoid risk of electrocution.

Step 4: Turn on the power switch. Once powering up the machine, it takes approximately 6 minutes to complete the warming-up process to make heater reach operating temperature to work.

Operation Instructions

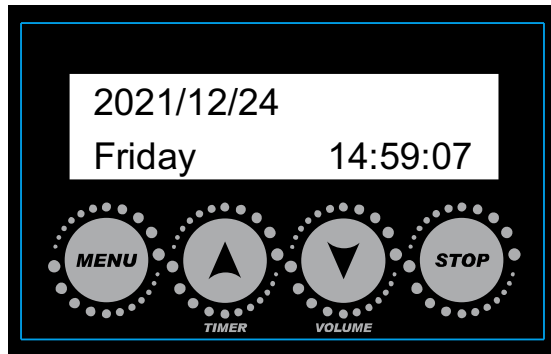

The date format is YYYY/MM/DD. The time format is HH:MM:SS.

The AG-1600 has a built-in clock and calendar. It is important to have an accurate clock setting to ensure proper operation of the schedule application. To adjust the date and/or time displayed, on the main menu page (Date/Time page), press and hold the **MENU** button for 3 seconds to enter the date/time setting mode. Use **▲ (UP/TIMER)** and **▼ (DOWN/VOLUME)** buttons to adjust the highlighted value. Once all changes have been made, press **STOP** button to confirm and save the selected setting.

Manual Mode (Volume Button):

The AG-1600 has a quick access button to manually operate the unit in either “Normal” or “High” mode. After the unit has reached operating temperature simply press the **▼ (DOWN /VOLUME)** button and the unit will immediately begin to fog in the preselected mode, and tap the **STOP** button to stop manual output. To change “Volume” output mode, tap the **MENU** button once while on the main menu page (Date/Time page), use the **▲ (UP/TIMER)** and **▼ (DOWN/VOLUME)** buttons to scroll to “Output Volume,” tap the **STOP** button once to toggle between “Normal” and “High” using the **▲ (UP/TIMER)** and **▼ (DOWN/VOLUME)** buttons. Once you make your selection tap the **STOP** button once again to confirm and save the desired setting.

Timer Mode:

The AG-1600 includes an advanced built-in electronic timer control that allows the unit to fog for a predetermined amount of time. To activate the timer simple press the **▲ (UP/TIMER)** while on the main menu page (Date/Time page).

To adjust the settings of the built-in timer tap the **MENU** button twice from the main menu page (Date/Time page) until “Timer” is displayed in the menu, then press the **STOP** button to access the different timer settings. There are three different settings that can be configured; Waiting Time,

Fogging Time, and Cycle Duration. Use the ▲ (UP/TIMER) and ▼ (DOWN/VOLUME) buttons to toggle between the different settings.

***Waiting Time** – is the amount of time in between blast and can be set between 00:10 (10 seconds) and 60:00 (60 minutes) by using ▲ (UP/TIMER) and ▼ (DOWN/VOLUME) buttons. Once a setting has been made press the **STOP** button once to confirm and save the setting.

***Fogging Time** - is the amount of time the unit will emit fog and can be set between 00:10 (10 seconds) and 60:00 (60 minutes) by using ▲ (UP/TIMER) and ▼ (DOWN/VOLUME) buttons. Once a setting has been made press the **STOP** once button to confirm and save the setting.

***Cycle Duration** – is the number of times the machine will repeat the above two settings before stopping and can be set between 1 and 20 times or Continuous by using ▲ (UP/TIMER) and ▼ (DOWN/VOLUME) buttons. Once a setting has been made press the **STOP** button once to confirm and save the setting.

Note: If cycle duration is set to “Continuous” the AG-1600 will continue to run the timer settings until the timer is switched off manually by pressing the **STOP** button.

Once all settings are made press **STOP** button again to exit the settings menu and return to the main menu page (Date/Time page), press ▲ (UP/TIMER) button to trigger Timer mode, and press **STOP** button to stop Timer mode.

Together the three different settings provide for an extremely flexible fogging cycle, for example: If you wish the AG-1600 to fog for 5 minutes every 30 minutes, three times, set the Waiting Time to 30:00 , the Fogging Time to 05:00, and the Cycle Duration to 3.

NOTE: At the end of the last cycle the AG-1600 will automatically go into stand-by mode in three minutes, shutting down the heater and display to conserve power.

Schedule Mode:

The AG-1600 comes with a built-in clock and calendar that allows the unit to be triggered automatically at any time. This feature is especially useful when wanting to sanitize a room or space late at night or any other time when a room is scheduled to be empty. There are two selectable schedules available: Schedule 1 and Schedule 2. Both schedules have the same function and both can be run simultaneously.

To access and activate the schedule 1 function tap the **MENU** button 3 times from the main menu

page (Date/Time page) until “Schedule 1” appears in the menu, you can then use the ▲ (UP/TIMER) and ▼ (DOWN/VOLUME) buttons to toggle between ON (activate) and OFF (deactivate).

To adjust the settings for schedule 1, press the **STOP** button while on “Schedule 1” in main menu page (Date/Time page) to access the different schedule settings. There are three different settings that can be configured; Day, Start Time, and Stop Time. Use the ▲ (UP/TIMER) and ▼ (DOWN/VOLUME) buttons to toggle between the different settings.

***Day set:** - Is the day or days the schedule 1 will activate and is represented by the following; S, M, T, W, T, F, S. and represent Sunday through Saturday respectively. Use the ▲ (UP/TIMER) and ▼ (DOWN/VOLUME) buttons to select the days you would like the AG-1600 to run. For example; If you would like the AG-1600 to run on Mondays and Wednesdays, adjust the days setting to read _ , M, _ , W, _ , _ , _ . Only the “M” (Monday) and “W” (Wednesday) should be displayed in the menu. Once you have finished your selection press the **STOP** button once to confirm and save the settings.

***Start Time** – is the time of day the AG-1600 will begin to fog. This setting is displayed in 24 hour time and can be adjusted between 00:00 and 23:59 by using the ▲ (UP/TIMER) and ▼ (DOWN/VOLUME) buttons. Once you have finished your selection press the **STOP** button once to confirm and save the settings.

***Stop Time** – is the time of day the AG-1600 will stop the fogging process. This setting is displayed in 24 hour time and can be adjusted between 00:00 and 23:59 by using the ▲ (UP/TIMER) and ▼ (DOWN/VOLUME) buttons. Once you have finished your selection press the **STOP** button once to confirm and save the settings.

Once all settings are made press **STOP** button again to exit the settings menu and return to the “Schedule 1” menu page and use the ▲ (UP/TIMER) and ▼ (DOWN/VOLUME) buttons to either activate or deactivate schedule 1.

Example of the schedule function: If you wish the AG-1500 to start to fog at 13:00 and stop fogging at 13:15 in the afternoon every Monday, the settings should be set as follows: Day: _ , M, _ , _ , _ , _ , _ . , Start Time: 13:00, Stop Time: 13:15,

To activate and change the setting for schedule two (2), tap the **MENU** button four (4) times from the main menu page (Date/Time page) until “Schedule 2” appears in the menu and follow the same instructions listed above for Schedule 1.

NOTE: At the end of a scheduled cycle, the AG-1600 will automatically go into stand-by mode in three minutes, shutting down the heater and display to conserve power.

Wireless Remote setting:

The AG-1600 wireless remote function can be turned off if necessary. On extremely rare occasions the AG-1600 may encounter wireless interference that will require the built-in wireless function to be switched off. To change the wireless setting, tap the **MENU** button five (5) times while on the main menu page (Date/Time page). After the fifth tap of the menu button the menu will switch to the Remote Settings page. Toggle between “ON” (active) and “OFF” (inactive) using the ▲ (**UP/TIMER**) and ▼ (**DOWN/VOLUME**) buttons. Once you make your selection tap the **STOP** button once to confirm and save the desired setting.

Wireless Remote Control Operation

Wireless remote control system consists of a transmitter equipped with two buttons to activate, deactivate and an onboard receiver attached to the rear panel of AG-1600.



W-1 Wireless Transmitter

Press button **A** to emit fog and press button **B** to stop.



Wireless Receiver

The maximum working distance of wireless remote is 50 meters. The distance varies, depending on transmitter’s battery level, and blockage and interference of radio signal.

Pair and Delete transmitters

Step 1: Power off AG-1600 Antibacterial Vaporizer

Step 2: Press and hold ▼ (**DOWN**) button

Step 3: Turn power on and release ▼ (DOWN) button when LCD display blinks

Step 4: Follow the instructions showed in the LCD display to pair or delete transmitters

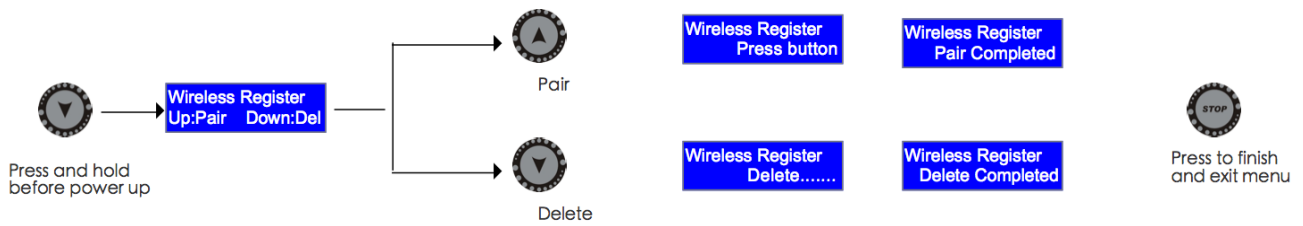

Notes:

One machine can be controlled by up to 10 transmitters while one transmitter can be paired with unlimited number of machines.

Transmitter battery replacement

If the wireless remote's working distance is reduced, it is possible the battery level is low. Undo the screws on the back of transmitter case and remove the cover. Replace with the same type and specification of battery which is 27A 12V.

Fluid



Use **Air Guard Antibacterial Solution** for AG-1600. The machine is tested and calibrated with these authorized fluids to achieve the best performance. Warranty will be void, if any other type of liquid is used. Improper use of liquid may lead to machine failure and danger.

Service and Maintenance

- Do not allow the machine and fluid to become contaminated.
- Regularly fill distilled water to fluid tank and run the machine to clean the system. After cleaning, refill Air Guard fluids into fluid tank and make sure machine can produce fog properly.
- It is recommended to run the machine on a monthly basis in order to achieve best performance and output condition.
- Excessive dust, liquid and dirt built up will degrade performance and cause overheating.

Breaker Reset



Disconnect AC power before resetting the breaker. Only replace fuse with same type and rating.

Step 1: Disconnect AC power.

Step 2: Flip breaker to ON position.

Step 3: Turn on machine for testing.

Breaker

100-120V = 15A 250V

220-240V = 8A 250V



Technical Specifications

- Input voltage	US model : AC 100-120V, 50 / 60Hz 12A EU model : AC 220-240V, 50 / 60Hz 6A
- Rated power	1450W
- Warm-up time	6 minutes (approx.)
- Maximum Fluid consumption	40 ml/min
- Fluid tank capacity	2.4L (0.63gal)
- Compatible fluid	Air Guard Antibacterial Solution
- Ambient temp. range	0 °C - 40 °C (32 °F-104 °F)
- Output height	2 meters height
- Control	Built-in Calendar Manual Wireless Remote Timer
- Connection	IEC (Power)
- Dimension	L344 W193 H381 mm (L13.54 W7.60 H15 inch)
- Weight	10.7 kg (23.6 lbs)



M22 Moisture Co., Ltd.

Tel : +886 3 2227470 Fax : +886 3 2227469

www.airguard.com.tw e-mail : sales@airguard.com.tw

C08AG1601

